

# FLOORPLANS & CAPACITIES

## MARIGOLD FLOORPLAN

The perfect Madison Square Park meeting space, Marigold I, II and III is the largest meeting space at this location. It allows for traditional conference style meetings, as well as total flexibility to accommodate unique setups and meal service. Air walls allow the room to be divided into three independent spaces, each of which is equipped with projectors and their own entrance to The Sequoia Salon, making it the perfect space to host large general sessions followed by independent breakout sessions.

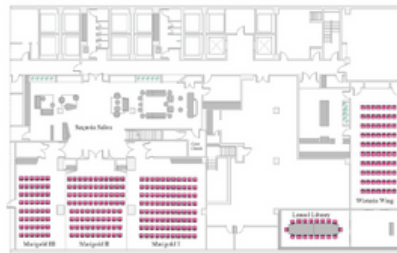
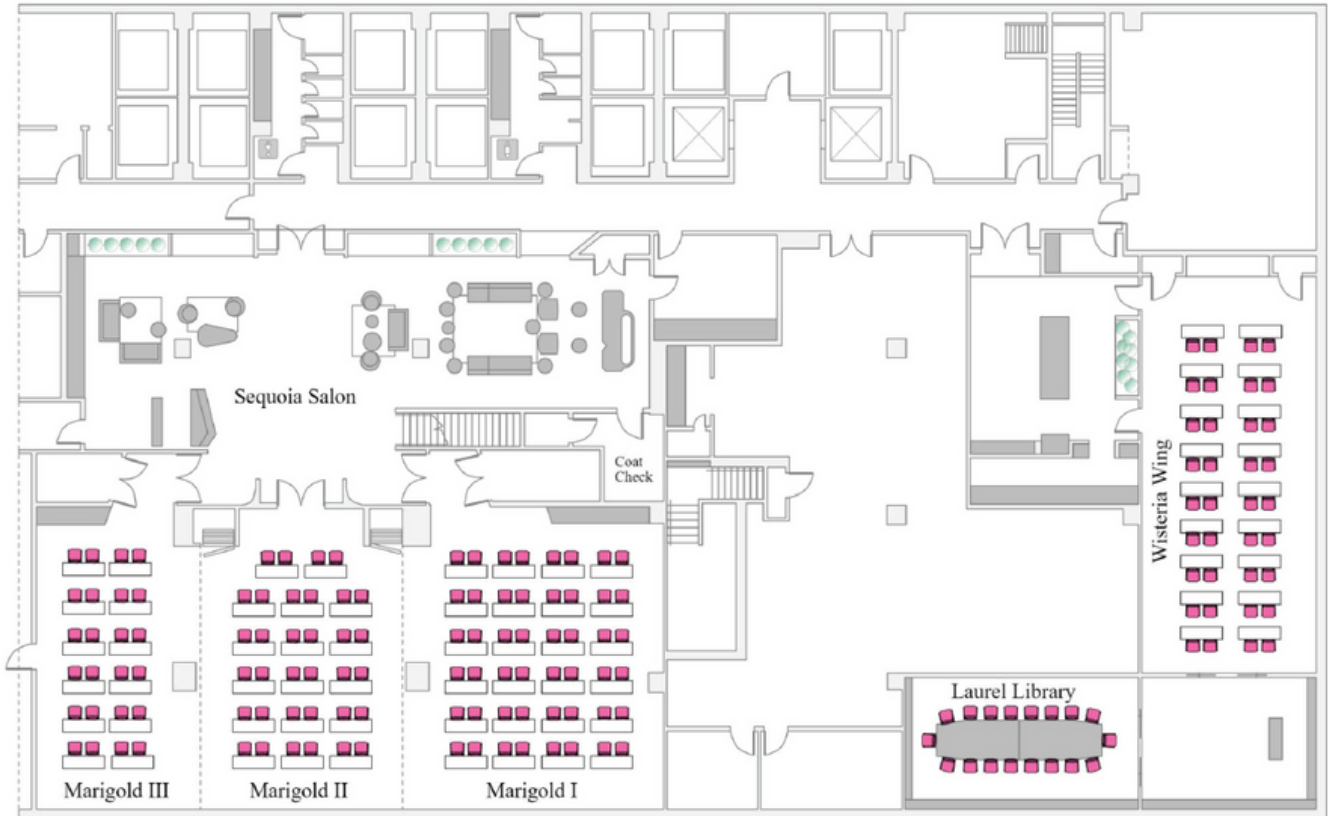

	DIMENSIONS	AREA (SQ FT)	CEILING HEIGHT	HOLLOW SQUARE	CONFERENCE	U-SHAPE	CLASSROOM	THEATER	RECEPTION	PODS
MARIGOLD I	31'X37'	1105	8'2" - 10'9"	30	16	24	48	60	75	36
MARIGOLD II	24'X32'	829	8'2" - 10'9"	30	16	24	48	60	75	36
MARIGOLD III	20'X37'	715	8'2" - 10'9"	24	16	22	20	36	40	24
MARIGOLD ALL	75'X37'	2669	8'2" - 10'9"	N/A	N/A	N/A	114	156	190	96
LAUREL LIBRARY	27'X14'	364	8'2"	N/A	18	N/A	N/A	N/A	N/A	N/A
WISTERIA WING	21'X47'	979	8'2"	32	24	28	42	49	60	36
SEQUOIA SALON	67'X23'	1492	8'2"	N/A	N/A	N/A	N/A	N/A	100	N/A